

## Kaleidoscope Autism Guide

Hello, welcome to Kaleidoscope. Here are some things you might like to know before you visit.

This is the layout of the community centre:

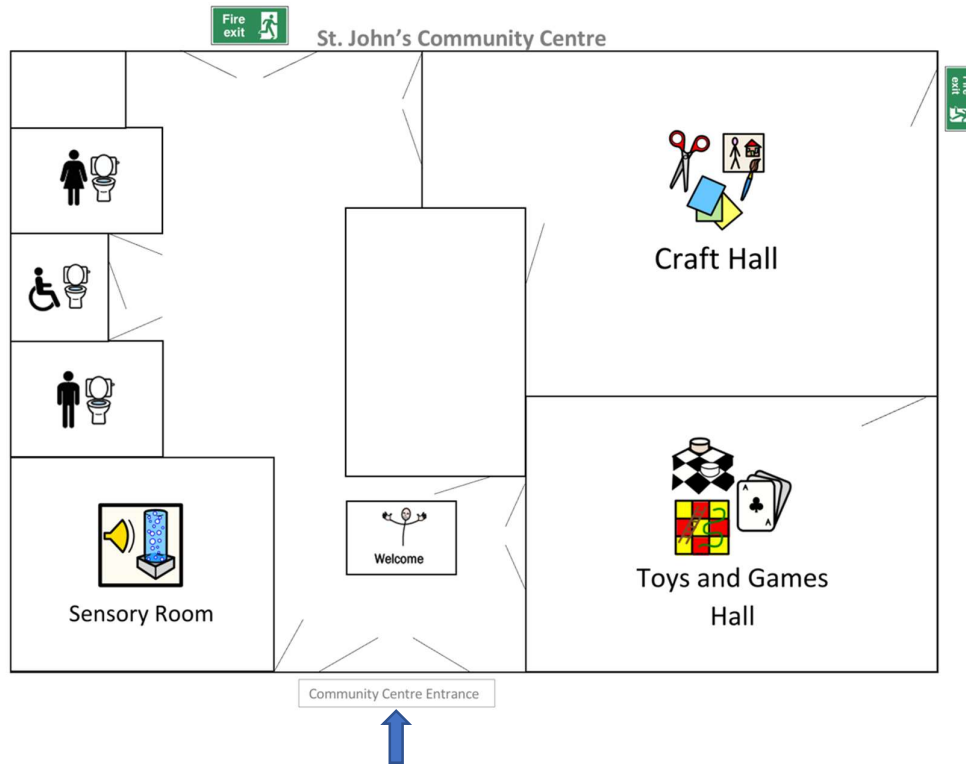

When you arrive, Peter, our friendly doorman, will welcome you and open the door for you.



At the welcome desk you will be able to find lots of things to help you. We have ear defenders, sand timers, visual timetables and fidget toys that you can borrow while you are with us.

There will be sticky labels and pens for you to write your name on. If it is your first time at Kaleidoscope the adult with you will be asked to complete a registration form.

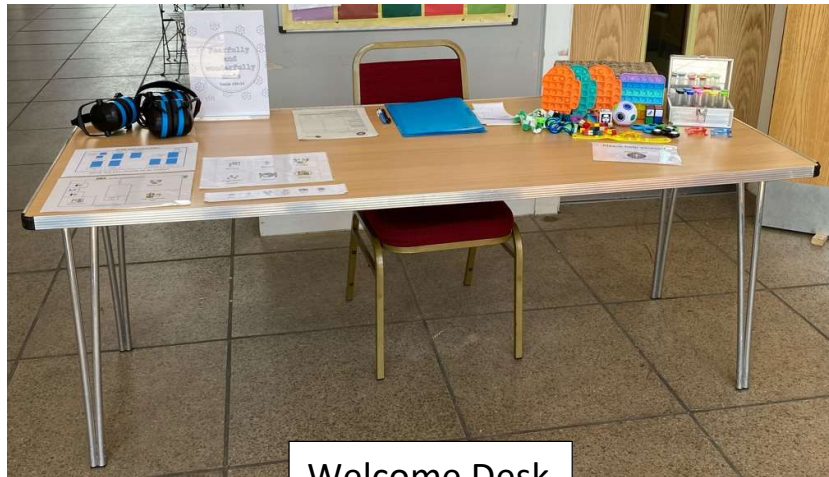

Welcome Desk

We have 3 main areas for you to use at Kaleidoscope. The first is our sensory room. There is a dark tent, a bubble tube, some soft mats and a gym ball. You can go to the sensory room whenever you want to and you can stay there for as long as you want to.

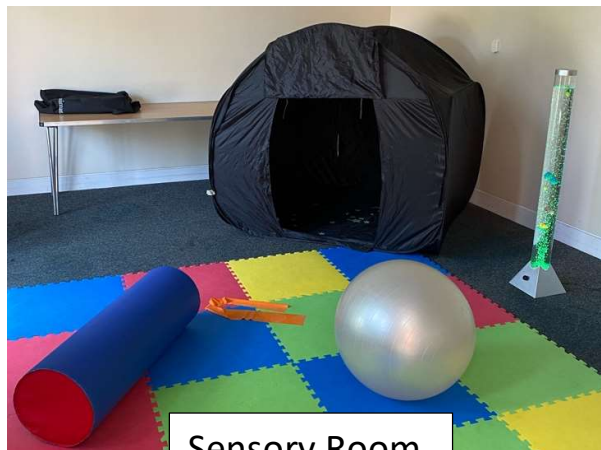

Sensory Room

In the craft hall there will be lots of tables set up with different activities. There will always be colouring, play-dough, sensory play and a food making or decorating activity. Other tables will change each time depending on the theme of the session.



Craft Hall

Every activity will have a sign to show you what you can do there. You can do any activity you would like to do. If there are any messy activities there will always be wipes to help you clean up afterwards.

We also have a toys and games hall. You can play in here. There will be games to play with others, toys to play with and soft play.



Toys and Games Hall

toys and games will be the same every month, some will change depending on the theme of the session.

Kaleidoscope starts at 4pm and finishes at 5.30pm. You can arrive and leave anytime within this period. You don't have to stay for the whole session.

We have a visual timetable for the session. It looks like this. You can borrow a timetable from the welcome desk.



Just before 5pm we will clear some space in the toys and games hall so we can all come together. We might have a sensory story, a game or a song. The activity will be different each month but it will always be at the same time and in the same place. You can be as involved as you want to be. You can still go to the sensory room during this time.

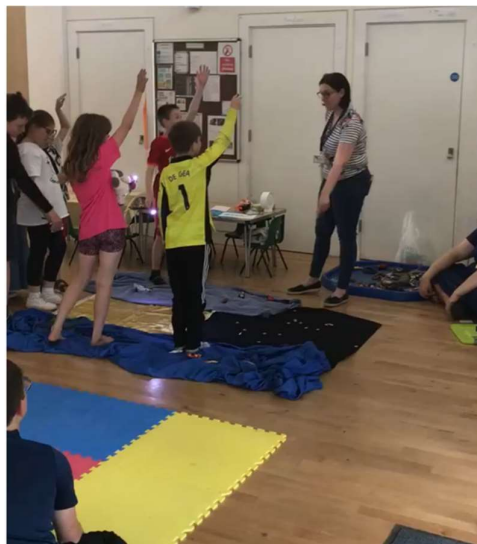

After our time together we will say a simple prayer and then go into the craft hall. The tables will now be set up with food. There will be sandwiches, crisps and salad. Afterwards there will be fruit and a selection of cakes and/or biscuits. You can choose where to sit. You can eat whatever you like. If you prefer, you can bring your own food from home or you can go home for dinner instead.

When you have finished eating it will be time to go home. Anything you have borrowed can go back to the welcome desk. You can take home anything that you made during the session.

If you have any questions about Kaleidoscope you can e-mail the church. Beccy Gregerson or Clare Luxton would be very happy to help.

The church e-mail address is: [office@stjohnscolchester.org.uk](mailto:office@stjohnscolchester.org.uk)